

SECTION II-A: SCHEMATIC

The following is a schematic of relevant 2nd floor areas assessed during the physical site survey at the XYZ Company facilities located at 1229 W. North Avenue, Chicago, Illinois 60614. Indexes of associated measurements and images taken as deemed relevant to the investigation of a July 14, 2014 fall experienced by Joseph M. Smith and can be referenced within subsequent subsections of this report.

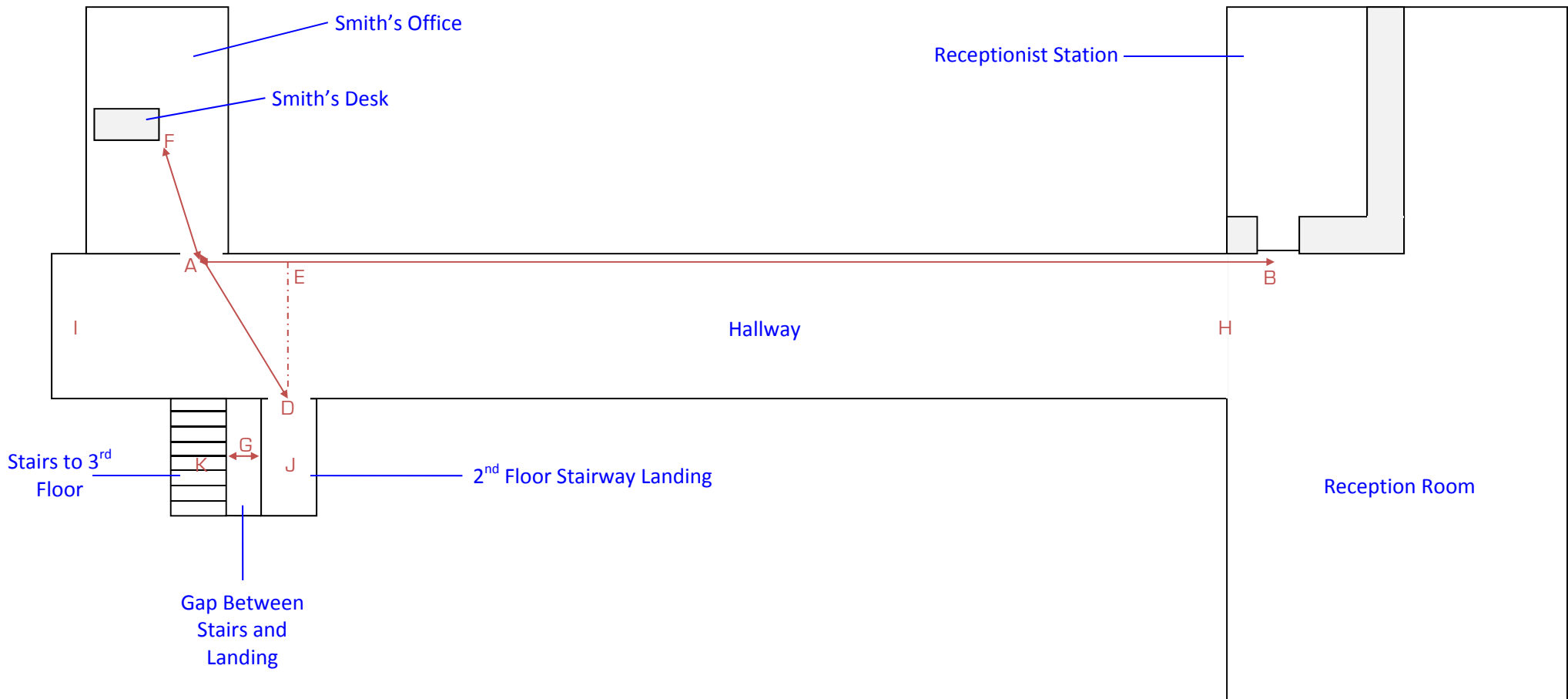

Not To Scale – For Reference Purposes Only